

★ **YODER SMOKERS** ★
PREMIUM GRILLS & SMOKERS

EL DORADO ROTISSERIE

INSTALLATION MANUAL

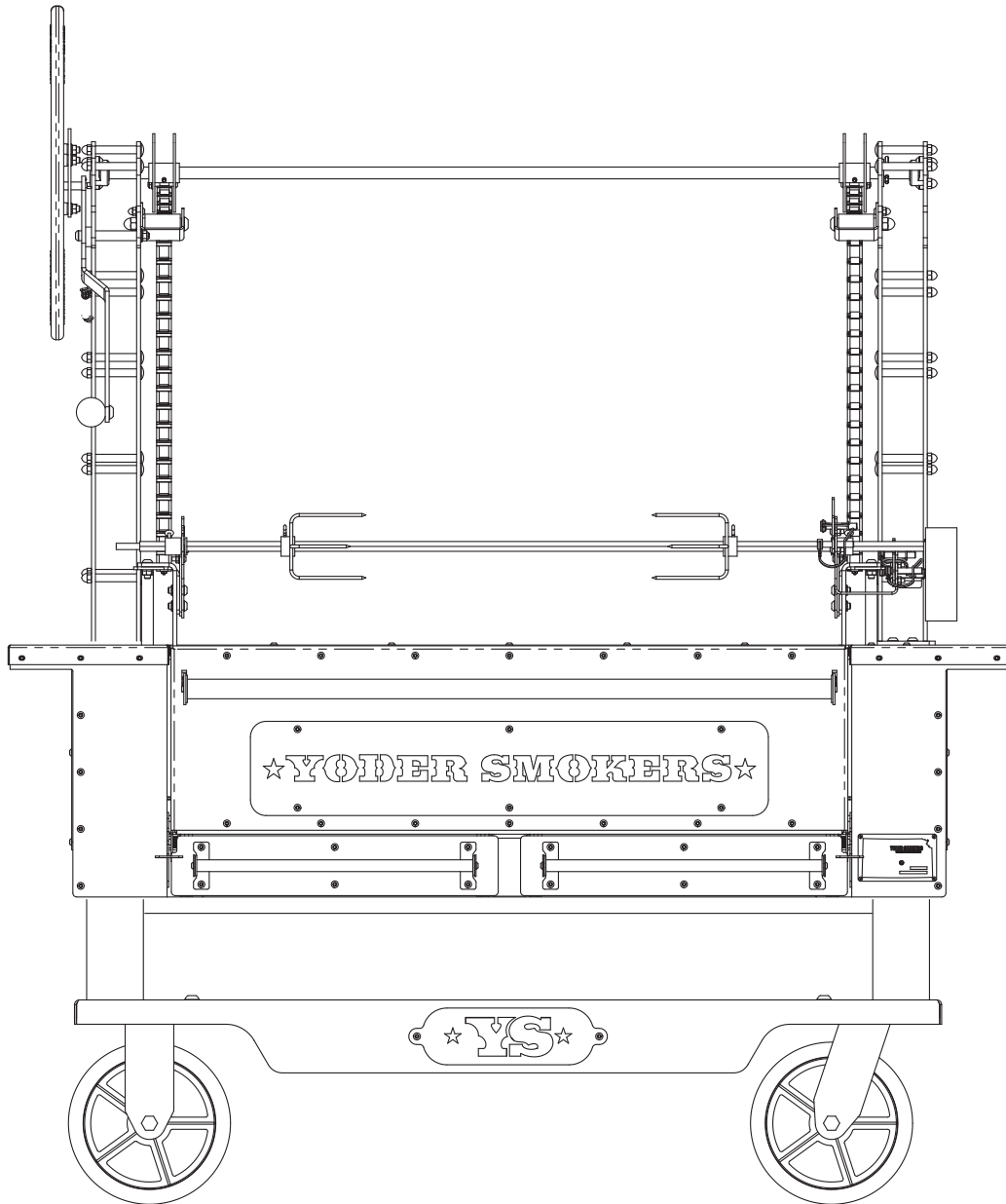

★ **YS** ★

★ YODER SMOKERS ★

PREMIUM GRILLS & SMOKERS

BEFORE YOU GET STARTED



Begin by confirming all the parts included in this kit are accounted for in this kit. *Should any items be missing, please contact Customer Service for assistance at 877.409.6337 or customerservice@yodersmokers.com.*

PARTS INCLUDED

(1) Spit Rod (2) Spit Rod Forks (2) Bushings (1) Motor with Bracket
(2) Mounting Brackets (9) Snap Pins (4) 3/8" Fasteners (4) 3/8" Nuts

TOOLS YOU'LL NEED

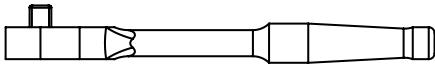
9/16" Socket Wrench | 9/16" Socket | 9/16" Wrench | 7/32" Hex Key

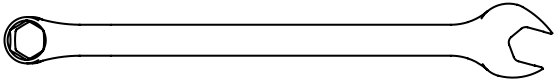
SOCKET WRENCH	
9/16" SOCKET	
7/32" HEX KEY	
9/16" WRENCH	

ATTACHING THE LEFT BRACKET

STEP 01

Use 3/8" bolts and nuts to attach the left-side support bracket to the lift support. Ensure the retainer arms face inward toward the grill as shown in the diagrams. Safety Warning: Use caution when tightening bolts to avoid pinch points.

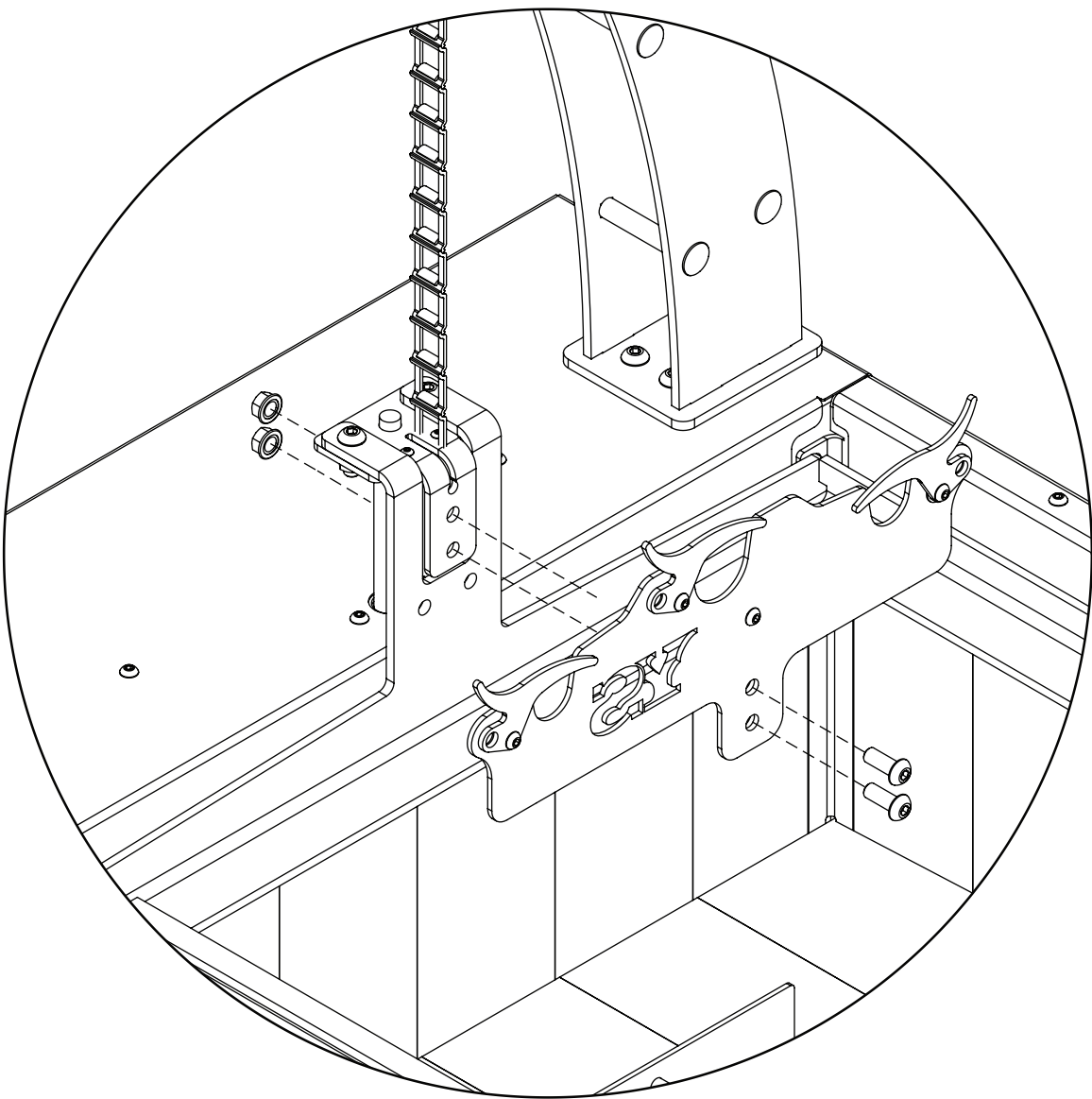

ATTACHING THE RIGHT BRACKET

STEP 02

Attach the right-side support bracket to the lift support using 3/8" bolts and nuts. Again, confirm that the retainer arms face inward toward the grill.

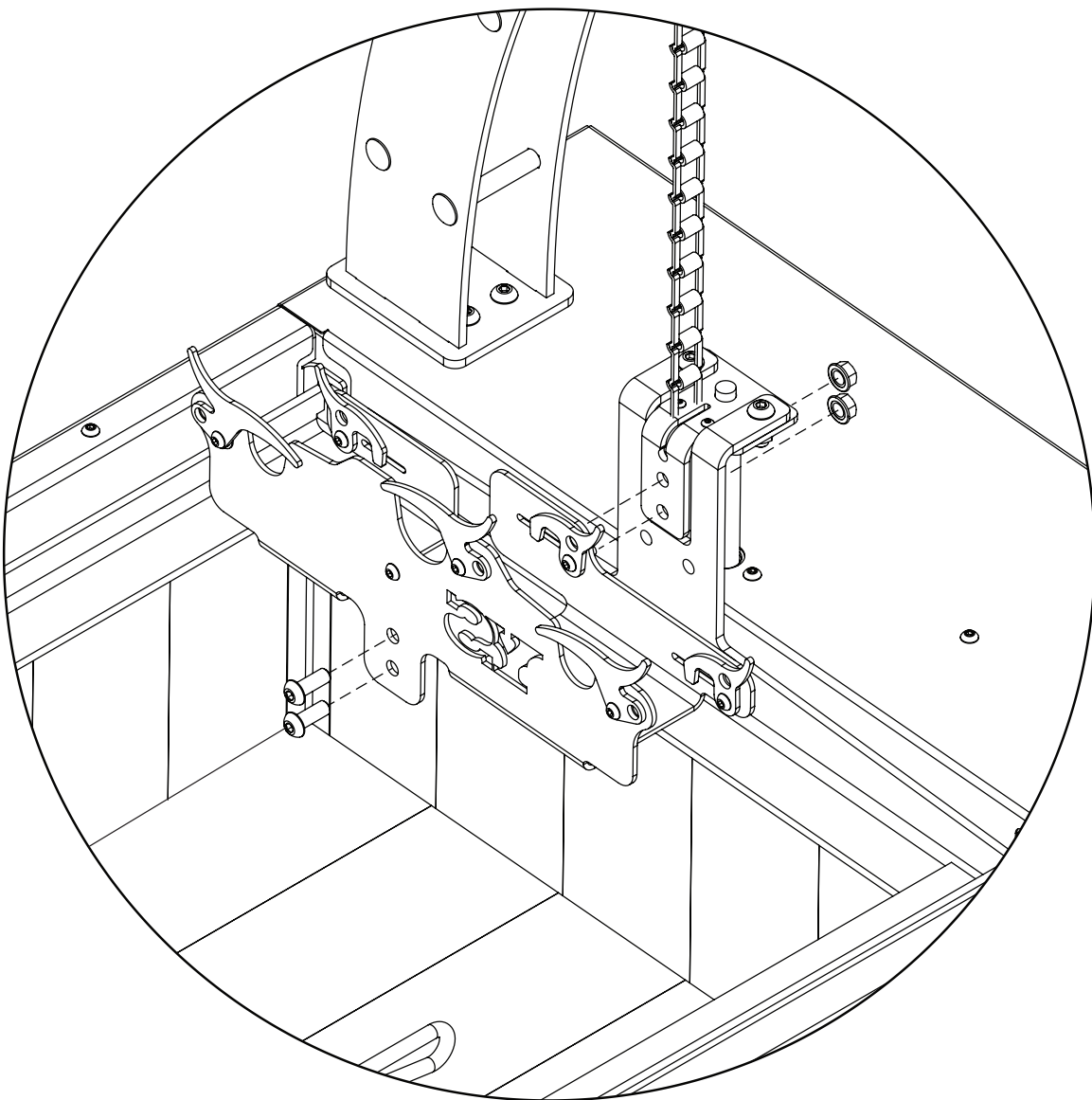

ASSEMBLE THE SPIT ROD

STEP 03

Assemble the spit rod by threading the sections together. Install a copper washer between sections to prevent binding. Load food onto the spit and secure it with the provided forks, tightening the set screws to lock them in position. Install a bushing on each end of the spit for proper support. Note: Tighten spit sections only enough to slightly compress the washer.

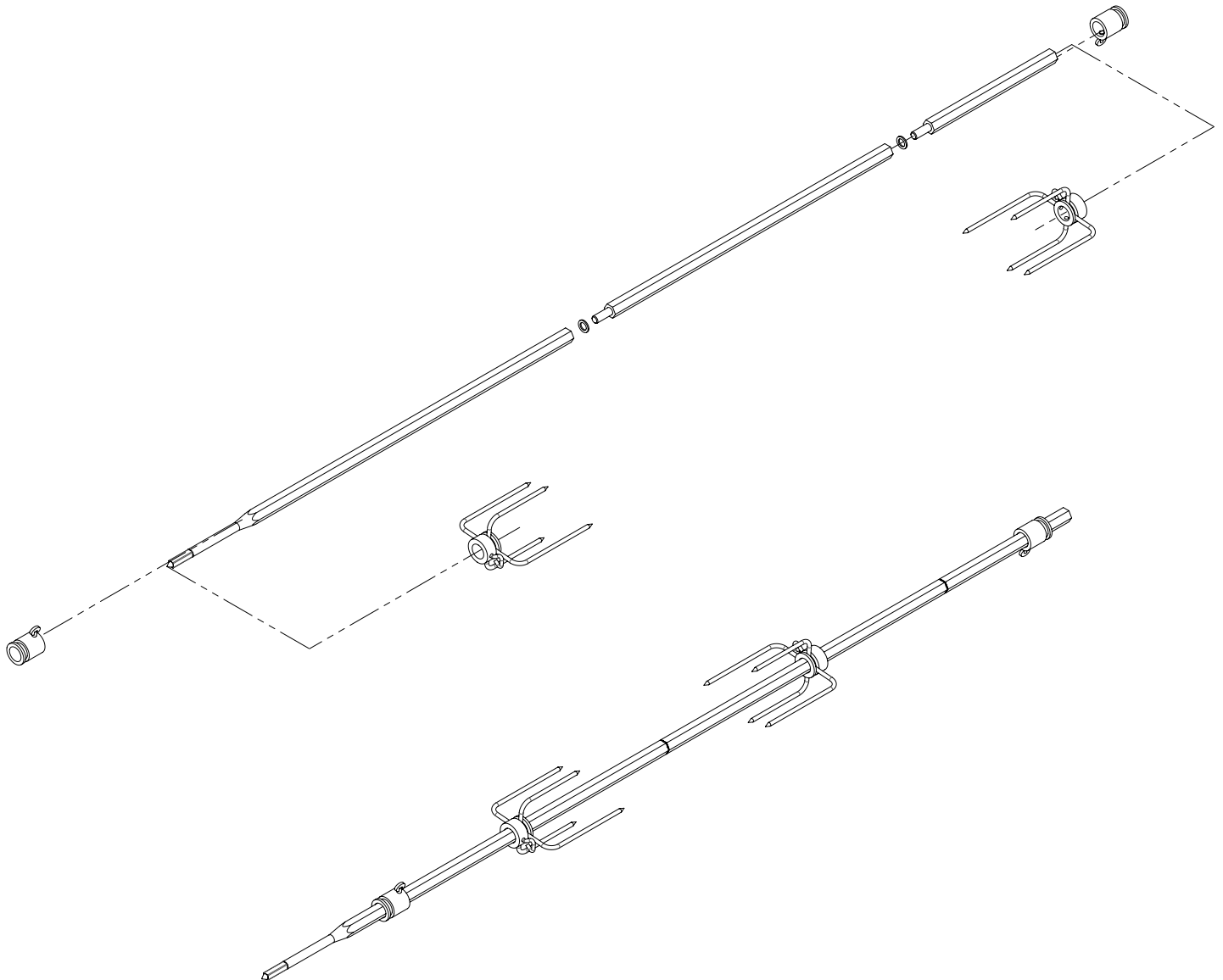

ATTACH THE SPIT ROD

STEP 04

Place the loaded spit rod into one of the three available positions. Align the bushing grooves with the support brackets, close the spit locks on both ends, and secure them with snap pins.

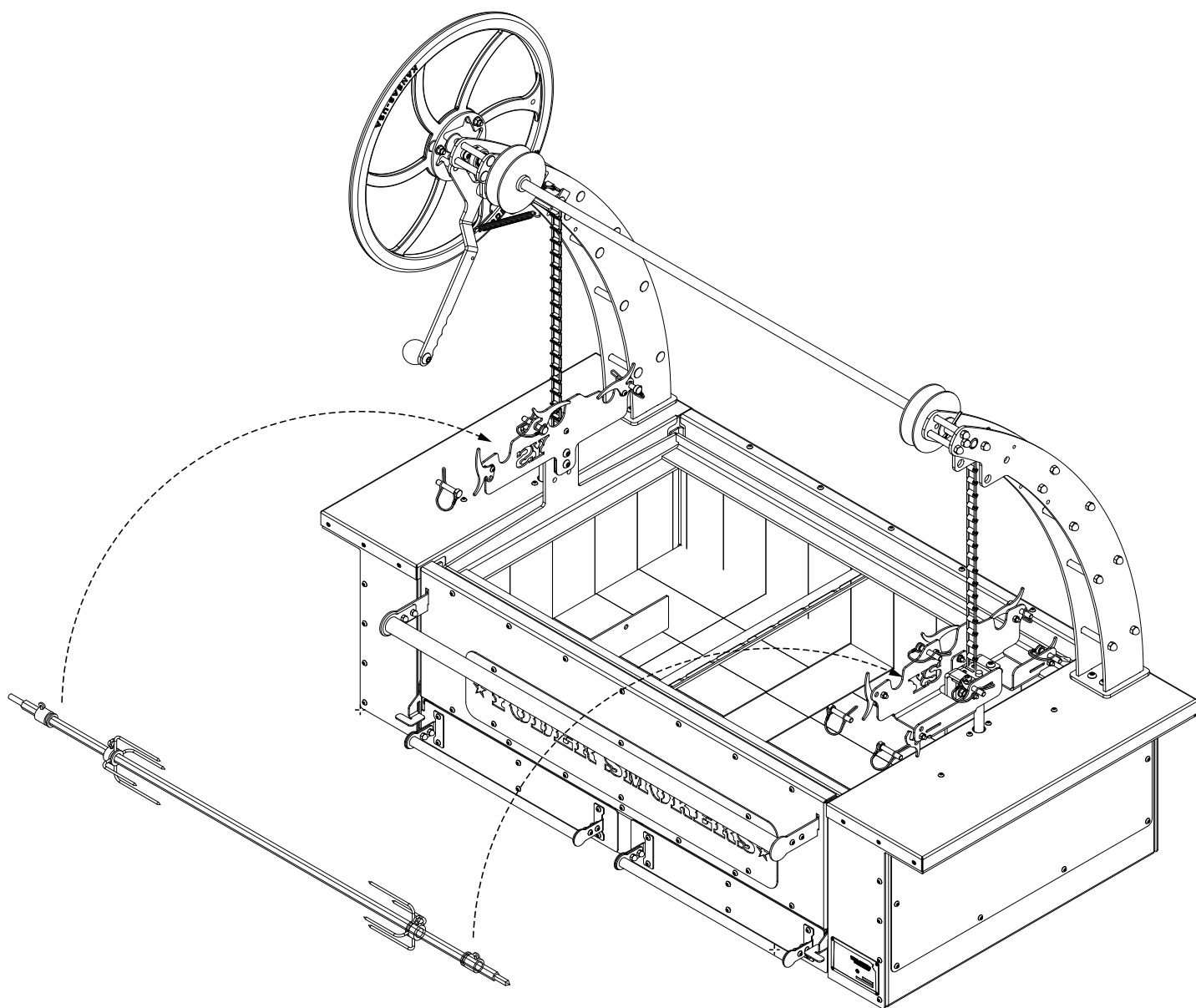

ATTACH THE MOTOR BRACKET

STEP 05

Slide the motor bracket upward into the motor retainers as shown. Support the bracket with one hand to keep it from sliding until fully seated. Tapping gently may help lock it into place.

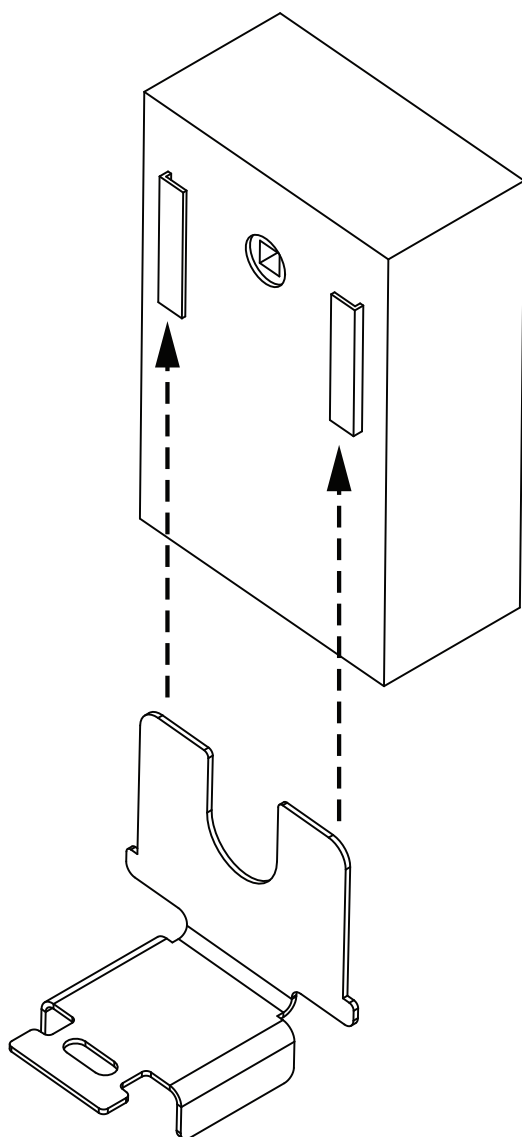

ATTACH THE MOTOR TO THE SPIT ROD

STEP 06

Align the motor with the end of the spit rod while guiding the bracket tab into the slot on the rotisserie bracket. Keep one hand supporting the bracket to prevent it from shifting. Caution: Keep the motor cord clear of hot surfaces and moisture..

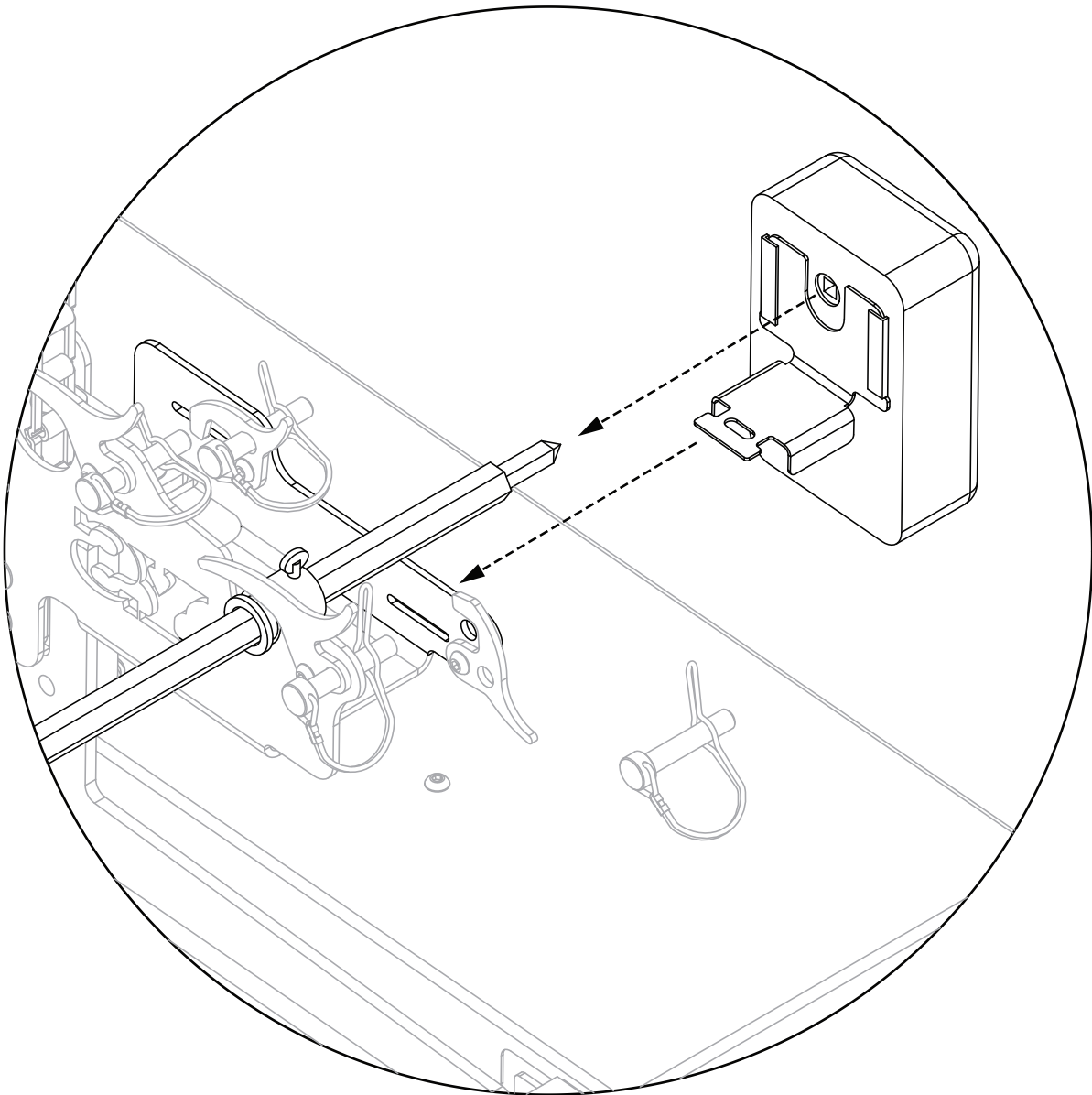

SECURE THE MOTOR BRACKET

STEP 07

With the motor attached to the spit rod, rotate the locking tab into position through the slot in the motor bracket. This locks the motor securely in place.

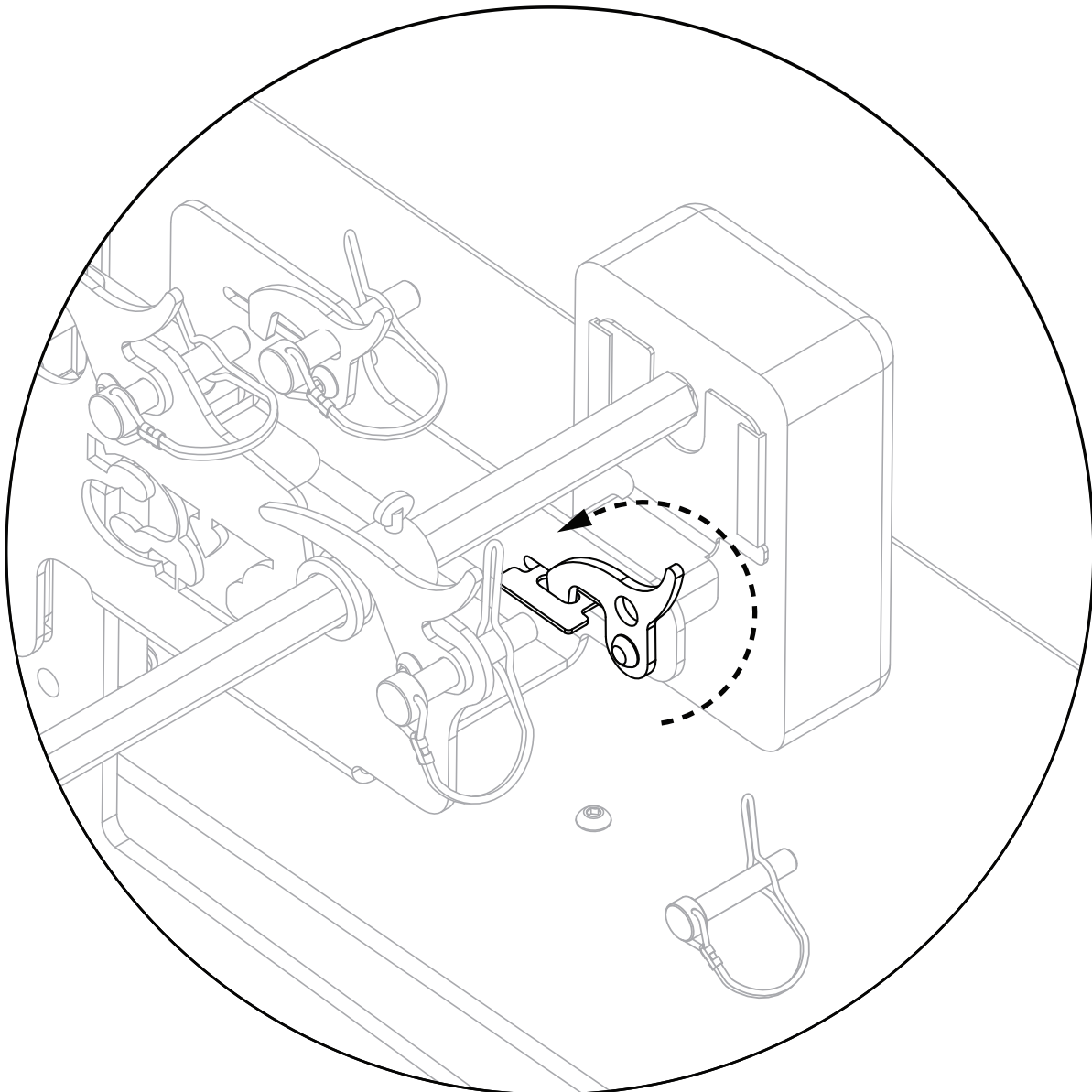

LOCK WITH SNAP PIN

STEP 08

Once the locking tab is rotated into place, insert a snap pin to secure the motor connection.

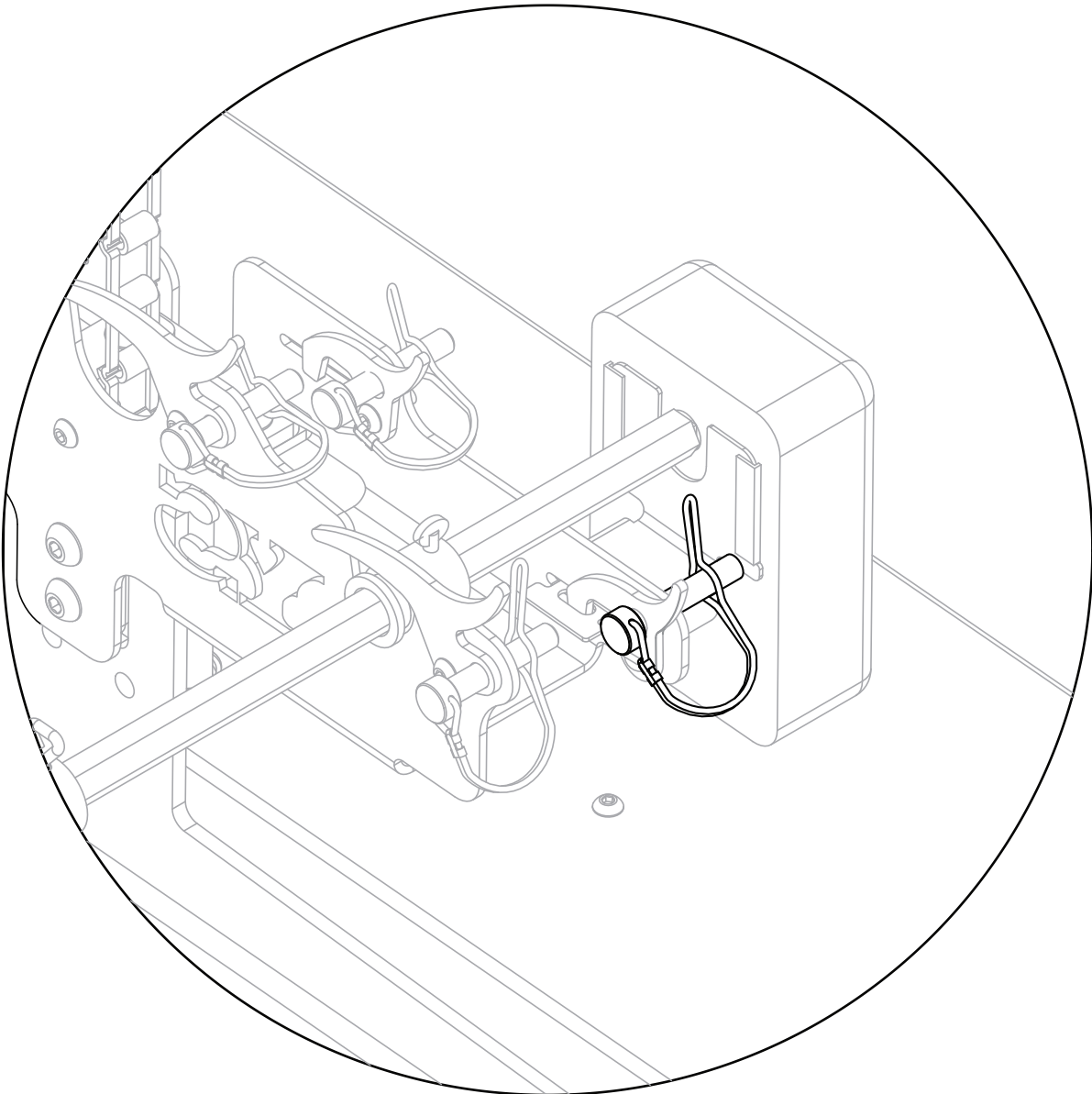

SECURE THE SPIT ROD

STEP 09

Tighten the thumbscrews on the bushings to lock the spit rod in position inside the support brackets.

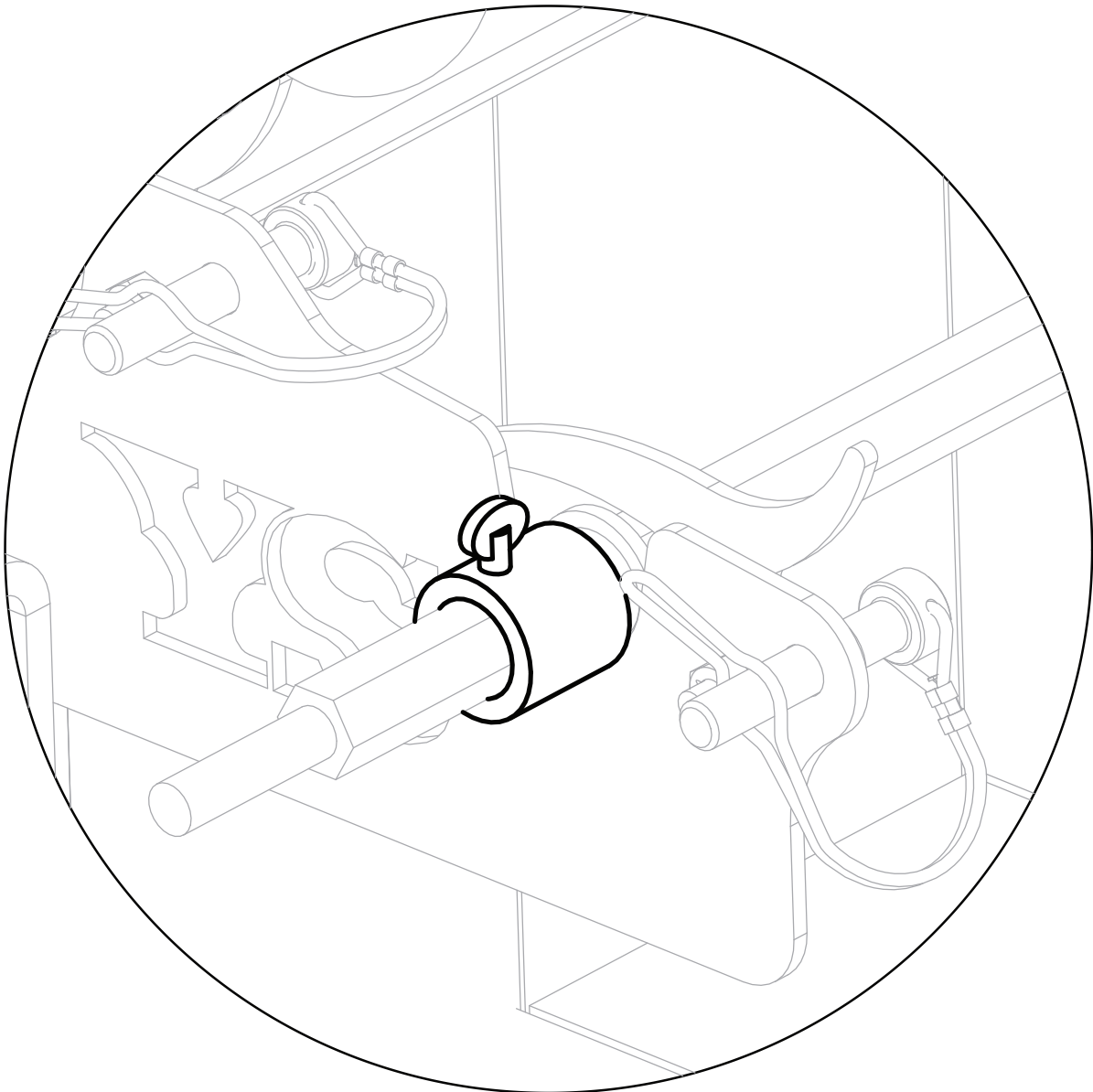

SECURE THE FORKS

STEP 10

After the spit rod is locked in, tighten the thumbscrews on the forks to fully secure them into position.

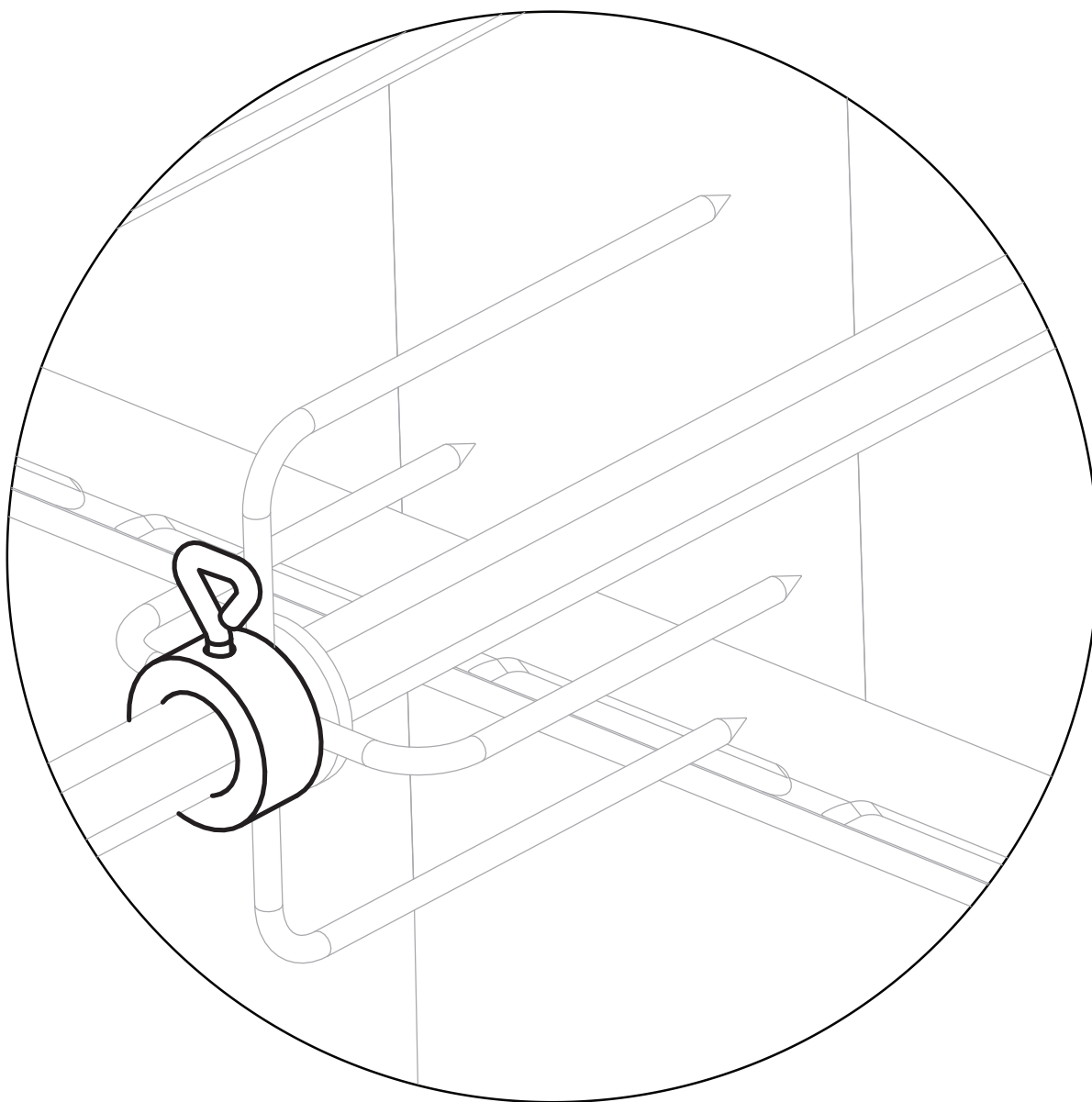

INSTALLATION COMPLETE
YOUR EL DORADO ROTISSERIE IS NOW READY FOR USE.



FOR PRODUCT SUPPORT:
CustomerService@YoderSmokers.com
877.409.6337 (OPTION 2)



QUESTIONS?

877.409.6337 | CUSTOMERSERVICE@YODERSMOKERS.COM.